

- Planning Application Boundary
- Habitat Survey Area (100m buffer of the site boundary as it was understood at the time of survey)
- Area Not Accessed
- Indicative Infrastructure Layout
- Permanent Infrastructure
- Temporary Infrastructure
- Ground Water Dependency
- Potential for Moderate Ground Water Dependency
- Potential for Partial Moderate Ground Water Dependency
- SBL Priority / Noteworthy Habitat
- Hedgerow
- Lowland Fen
- Purple Moor Grass and Rush Pasture
- Wet Woodland



NOTES

Note: Habitat labels depict NVC Communities Contains OS data © Crown copyright 2025

ISSUE PURPOSE

EIA REPORT

PROJECT NUMBER

60707131

FIGURE TITLE

Scottish Biodiversity List (SBL) Priority Habitats and Otherwise Noteworthy Habitats

FIGURE NUMBER

Figure 7.5 (Sheet 1 of 12)

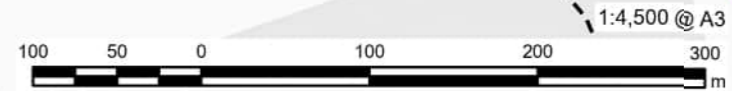

This drawing has been prepared for the use of AECOM's client. It may not be used, modified, reproduced or relied upon by third parties, except as agreed by AECOM's client. AECOM accepts no responsibility, and disclaims any liability whatsoever, to any party that uses or relies on this drawing without AECOM's express written consent. Do not scale this document. All measurements must be obtained from the allied dimensions.

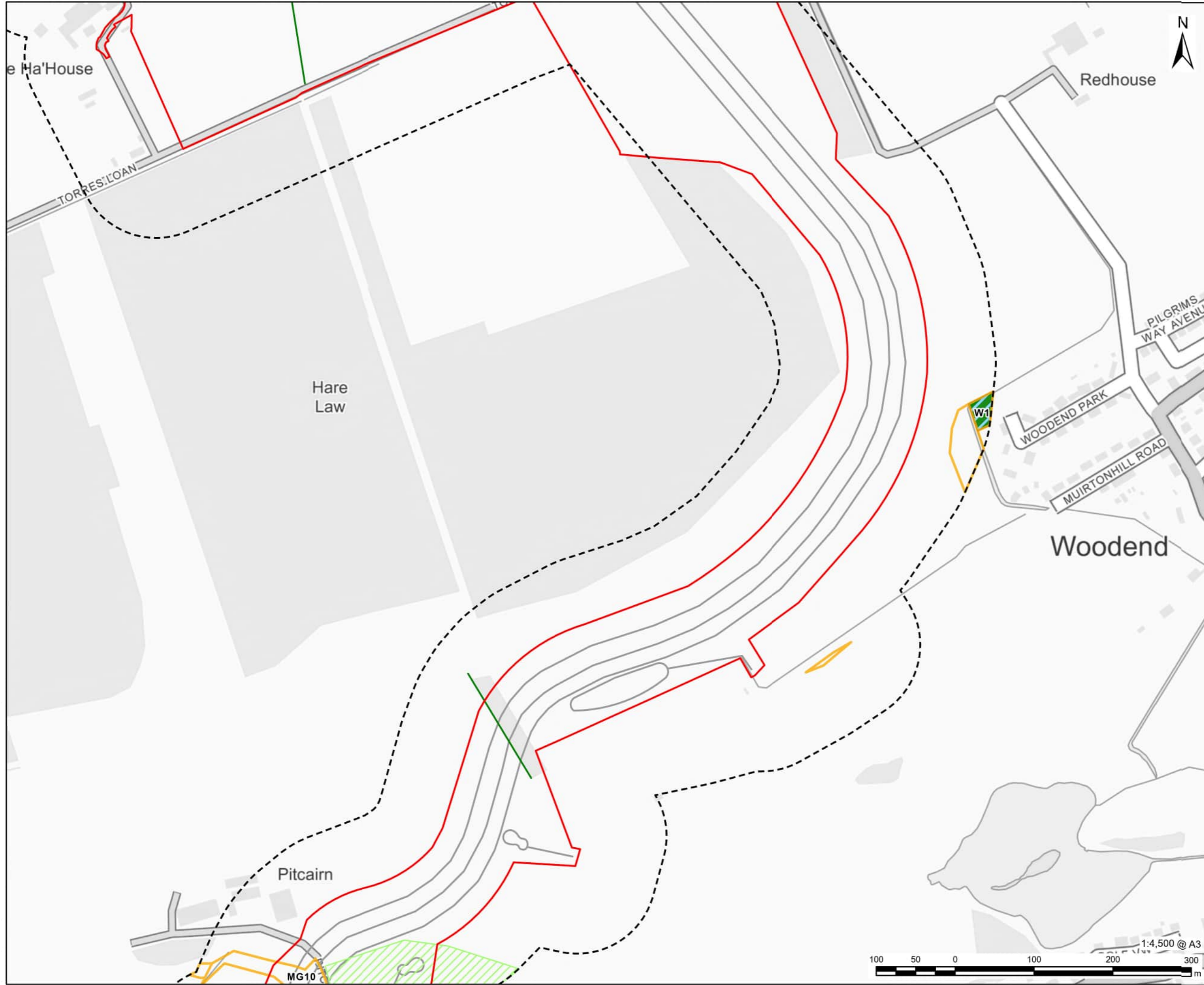

# AECOM

**PROJECT**

Eastern Green Link 4

**CLIENT**

SP Energy Networks

**CONSULTANT**

AECOM Limited  
 One Trinity Gardens  
 Newcastle  
 NE1 2HF  
 www.aecom.com

**LEGEND**

- Planning Application Boundary
- Habitat Survey Area (100m buffer of the site boundary as it was understood at the time of survey)
- Area Not Accessed
- Indicative Infrastructure Layout
  - Temporary Infrastructure
- Ground Water Dependency
  - Potential for Moderate Ground Water Dependency
- SBL Priority / Noteworthy Habitat
  - Hedgerow
  - Wet Woodland



**NOTES**

Note: Habitat labels depict NVC Communities  
 Contains OS data © Crown copyright 2025

**ISSUE PURPOSE**

EIA REPORT

**PROJECT NUMBER**

60707131

**FIGURE TITLE**

Scottish Biodiversity List (SBL) Priority Habitats and Otherwise Noteworthy Habitats

**FIGURE NUMBER**

Figure 7.5 (Sheet 2 of 12)

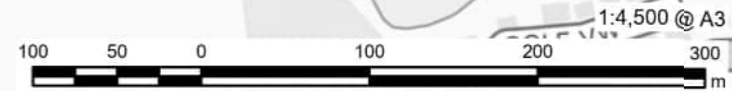

This drawing has been prepared for the use of AECOM's client. It may not be used, modified, reproduced or relied upon by third parties, except as agreed by AECOM or as required by law. AECOM accepts no responsibility, and denies any liability whatsoever, to any party that uses or relies on this drawing without AECOM's express written consent. Do not scale this document. All measurements must be obtained from the stated dimensions.

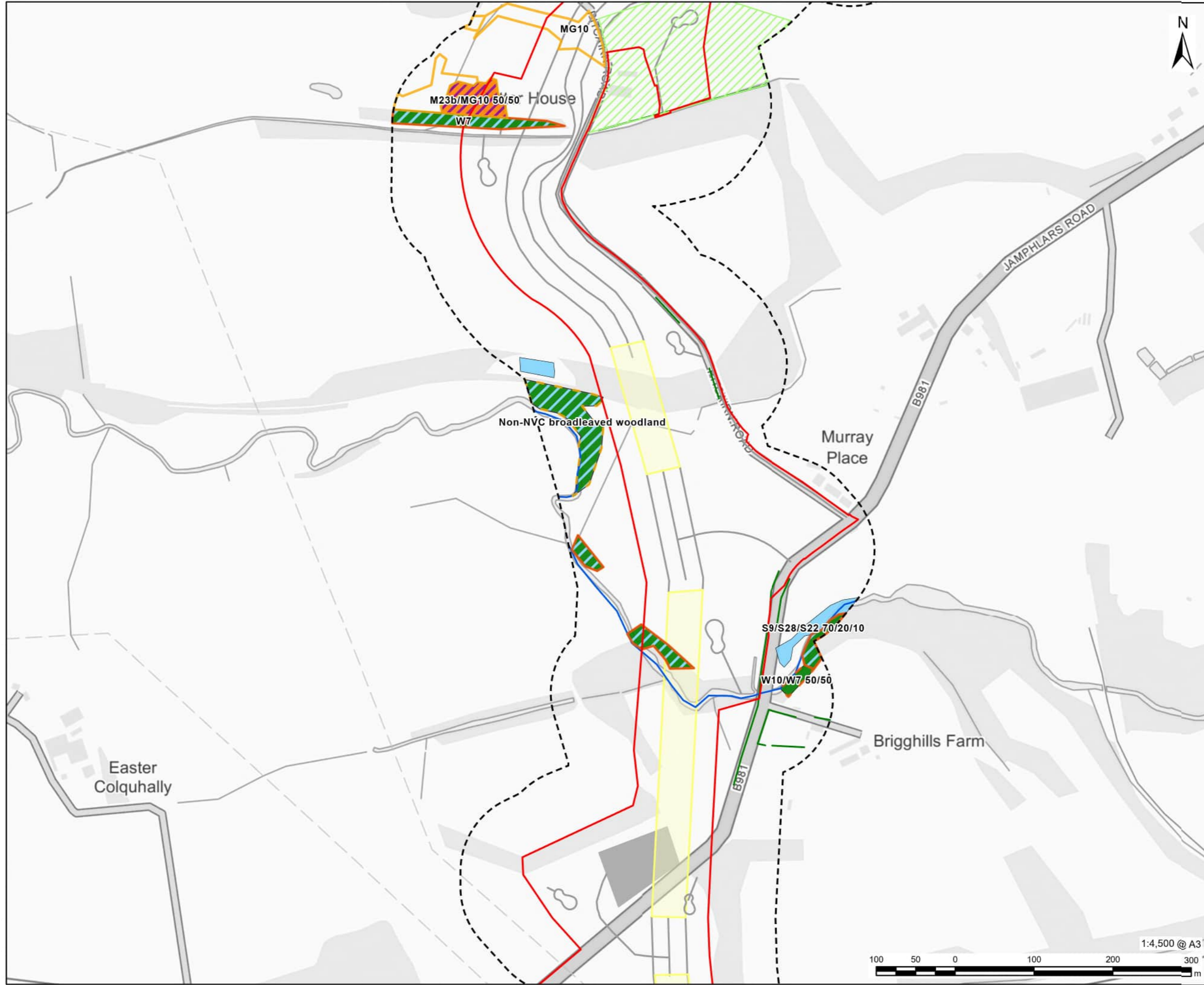

- LEGEND**
- Planning Application Boundary
  - Habitat Survey Area (100m buffer of the site boundary as it was understood at the time of survey)
  - Area Not Accessed
  - Indicative Infrastructure Layout**
  - Temporary Infrastructure
  - Horizontal Direction Drilling (HDD) Section
  - Ground Water Dependency**
  - Potential for High Ground Water Dependency
  - Potential for Partial High Ground Water Dependency
  - Potential for Moderate Ground Water Dependency
  - Potential for Partial Moderate Ground Water Dependency
  - SBL Priority / Noteworthy Habitat**
  - Hedgerow
  - River
  - Lowland Mixed Deciduous Woodland
  - Otherwise Noteworthy Wetland
  - Purple Moor Grass and Rush Pasture
  - Wet Woodland



**NOTES**  
Note: Habitat labels depict NVC Communities  
Contains OS data © Crown copyright 2025

**ISSUE PURPOSE**  
EIA REPORT

**PROJECT NUMBER**  
60707131

**FIGURE TITLE**  
Scottish Biodiversity List (SBL) Priority Habitats and Otherwise Noteworthy Habitats

**FIGURE NUMBER**  
Figure 7.5 (Sheet 3 of 12)



This drawing has been prepared for the use of AECOM's client. It may not be used, modified, reproduced or relied upon by third parties, except as agreed by AECOM. AECOM accepts no responsibility, and denies any liability whatsoever, to any party that uses or relies on this drawing without AECOM's express written consent. Do not scale this document. All measurements must be obtained from the allied dimensions.

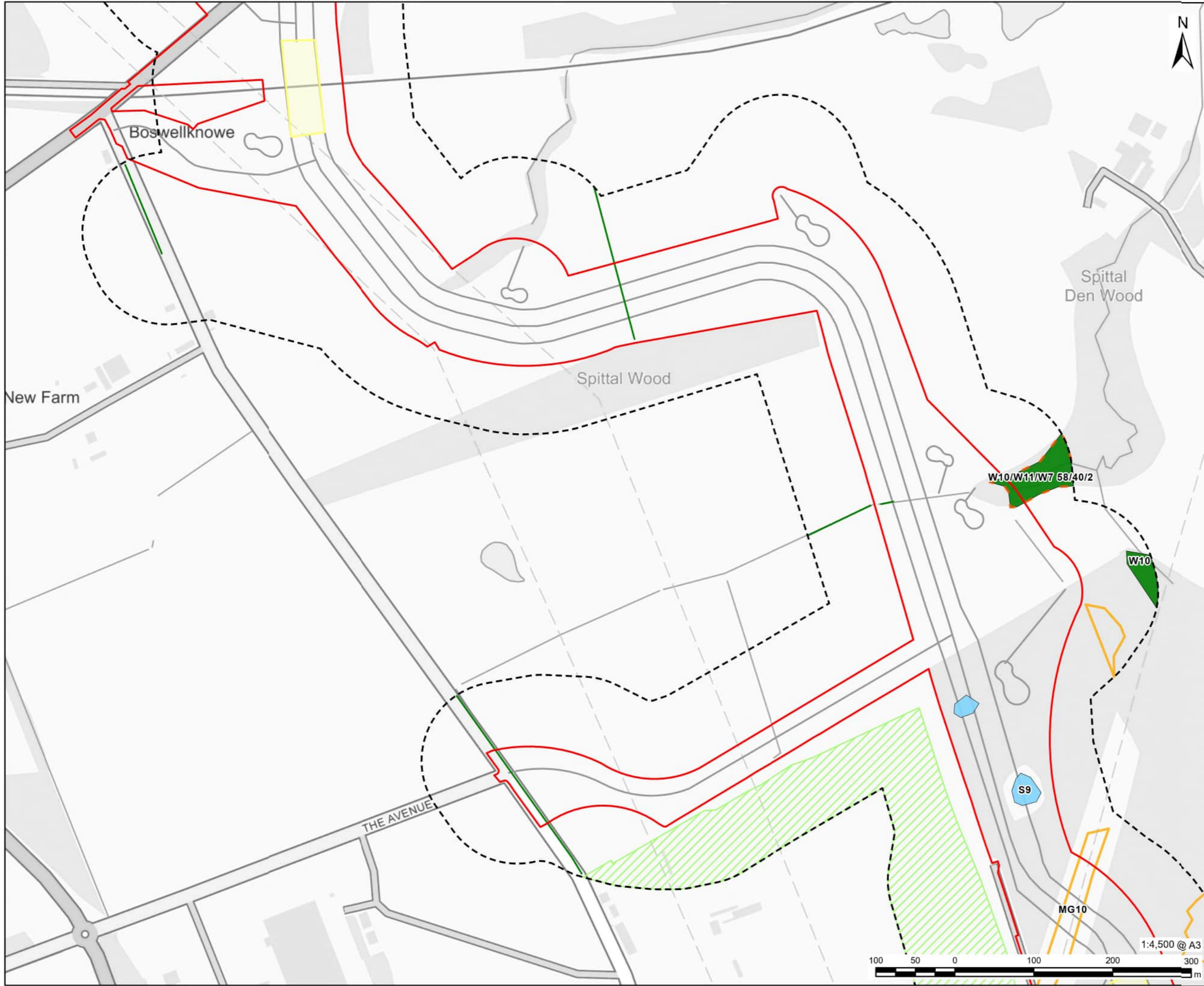

- LEGEND**
- Planning Application Boundary
  - Habitat Survey Area (100m buffer of the site boundary as it was understood at the time of survey)
  - Area Not Accessed
  - Indicative Infrastructure Layout**
  - Temporary Infrastructure
  - Horizontal Direction Drilling (HDD) Section
  - Ground Water Dependency**
  - Potential for Partial High Ground Water Dependency
  - Potential for Moderate Ground Water Dependency
  - SBL Priority / Noteworthy Habitat**
  - Hedgerow
  - Lowland Mixed Deciduous Woodland
  - Otherwise Noteworthy Wetland



**NOTES**  
Note: Habitat labels depict NVC Communities  
Contains OS data © Crown copyright 2025

**ISSUE PURPOSE**  
EIA REPORT

**PROJECT NUMBER**  
60707131

**FIGURE TITLE**  
Scottish Biodiversity List (SBL) Priority Habitats and Otherwise Noteworthy Habitats

**FIGURE NUMBER**  
Figure 7.5 (Sheet 4 of 12)



This drawing has been prepared for the use of AECOM's client. It may not be used, modified, reproduced or relied upon by third parties, except as agreed by AECOM or as required by law. AECOM accepts no responsibility, and disclaims any liability whatsoever, to any party that uses or relies on this drawing without AECOM's express written consent. Do not scale this document. All measurements must be obtained from the allowed dimensions.

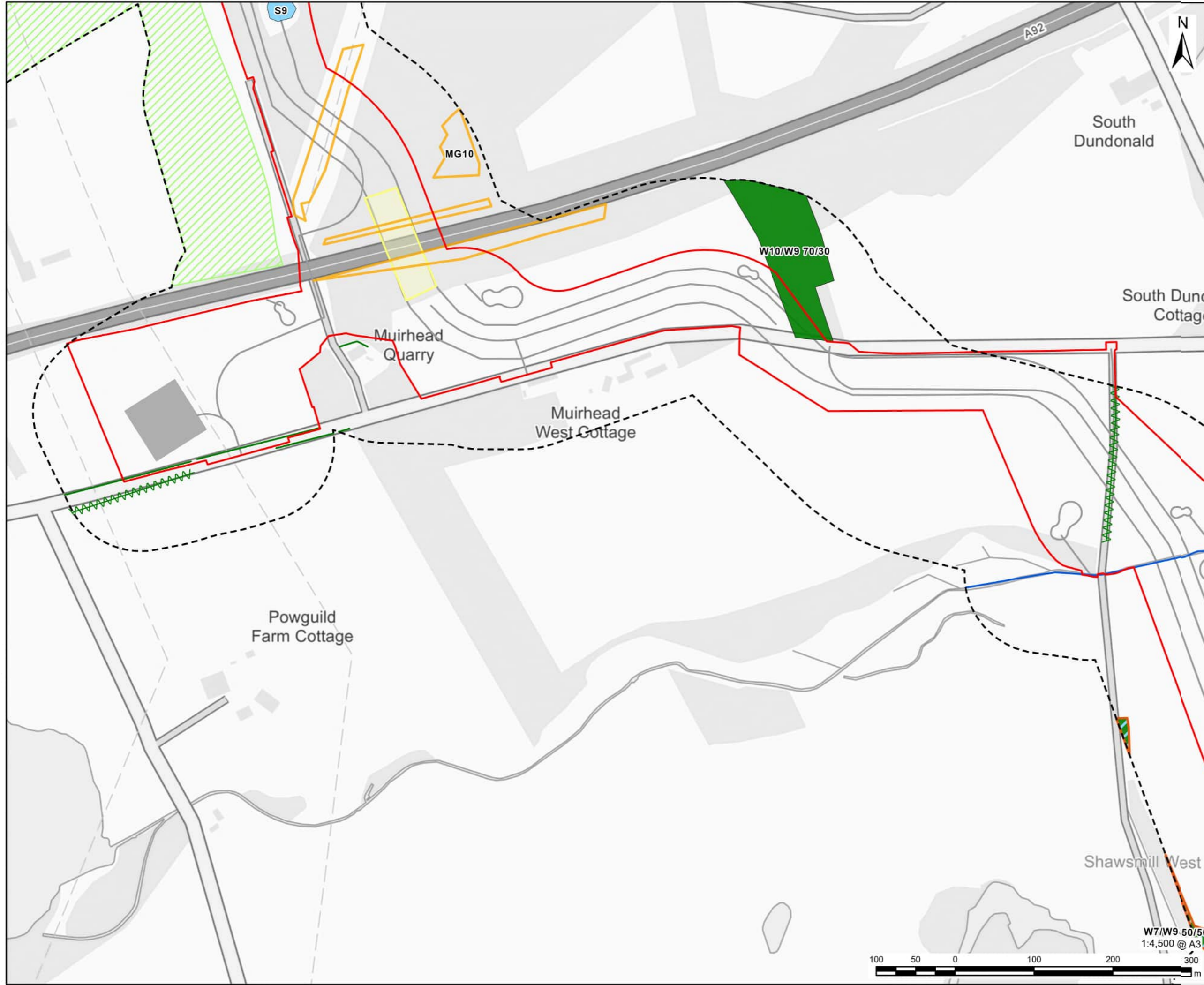

- Planning Application Boundary
- Habitat Survey Area (100m buffer of the site boundary as it was understood at the time of survey)
- Area Not Accessed
- Indicative Infrastructure Layout**
- Temporary Infrastructure
- Horizontal Direction Drilling (HDD) Section
- Ground Water Dependency**
- Potential for High Ground Water Dependency
- Potential for Moderate Ground Water Dependency
- SBL Priority / Noteworthy Habitat**
- Hedgerow (species-rich)
- Hedgerow
- River
- Lowland Mixed Deciduous Woodland
- Otherwise Noteworthy Wetland
- Wet Woodland



**NOTES**

Note: Habitat labels depict NVC Communities  
Contains OS data © Crown copyright 2025

**ISSUE PURPOSE**

EIA REPORT

**PROJECT NUMBER**

60707131

**FIGURE TITLE**

Scottish Biodiversity List (SBL) Priority Habitats and Otherwise Noteworthy Habitats

**FIGURE NUMBER**

Figure 7.5 (Sheet 5 of 12)

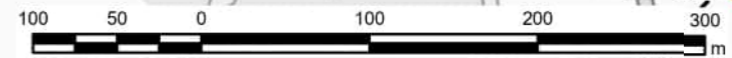

This drawing has been prepared for the use of AECOM's client. It may not be used, modified, reproduced or relied upon by third parties, except as agreed by AECOM's client. AECOM accepts no responsibility, and disclaims any liability whatsoever, to any party that uses or relies on this drawing without AECOM's express written consent. Do not scale this document. All measurements must be obtained from the allied dimensions.

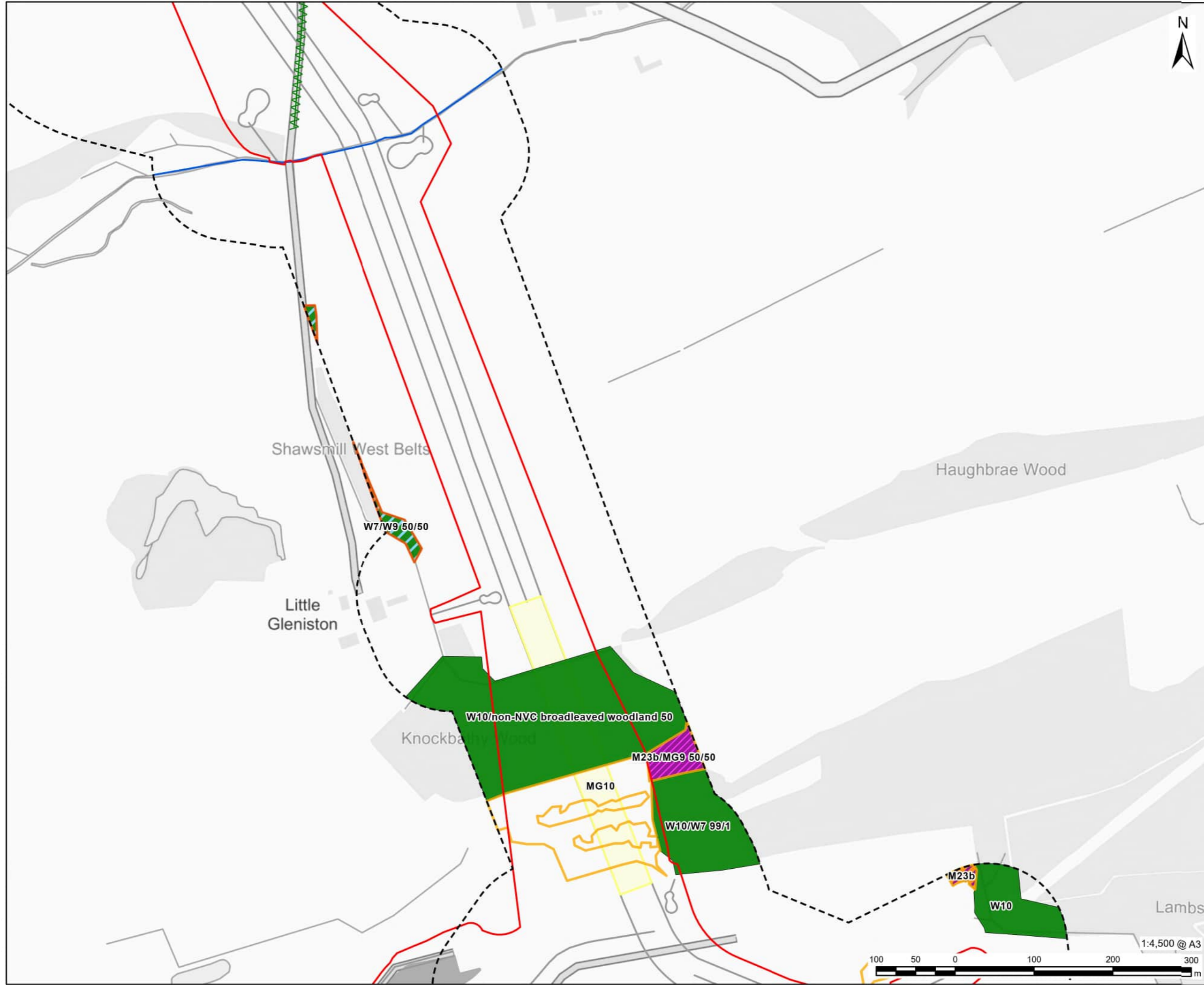

# AECOM

PROJECT

Eastern Green Link 4

CLIENT

SP Energy Networks

CONSULTANT

AECOM Limited  
One Trinity Gardens  
Newcastle  
NE1 2HF  
www.aecom.com

LEGEND

- Planning Application Boundary
- Habitat Survey Area (100m buffer of the site boundary as it was understood at the time of survey)
- Area Not Accessed
- Indicative Infrastructure Layout
- Temporary Infrastructure
- Horizontal Direction Drilling (HDD) Section
- Ground Water Dependency
- Potential for High Ground Water Dependency
- Potential for Moderate Ground Water Dependency
- SBL Priority / Noteworthy Habitat
- Hedgerow (species-rich)
- River
- Lowland Fen
- Lowland Mixed Deciduous Woodland
- Purple Moor Grass and Rush Pasture
- Wet Woodland



**NOTES**

Note: Habitat labels depict NVC Communities Contains OS data © Crown copyright 2025

**ISSUE PURPOSE**

EIA REPORT

**PROJECT NUMBER**

60707131

**FIGURE TITLE**

Scottish Biodiversity List (SBL) Priority Habitats and Otherwise Noteworthy Habitats

**FIGURE NUMBER**

Figure 7.5 (Sheet 6 of 12)



1:4,500 @ A3



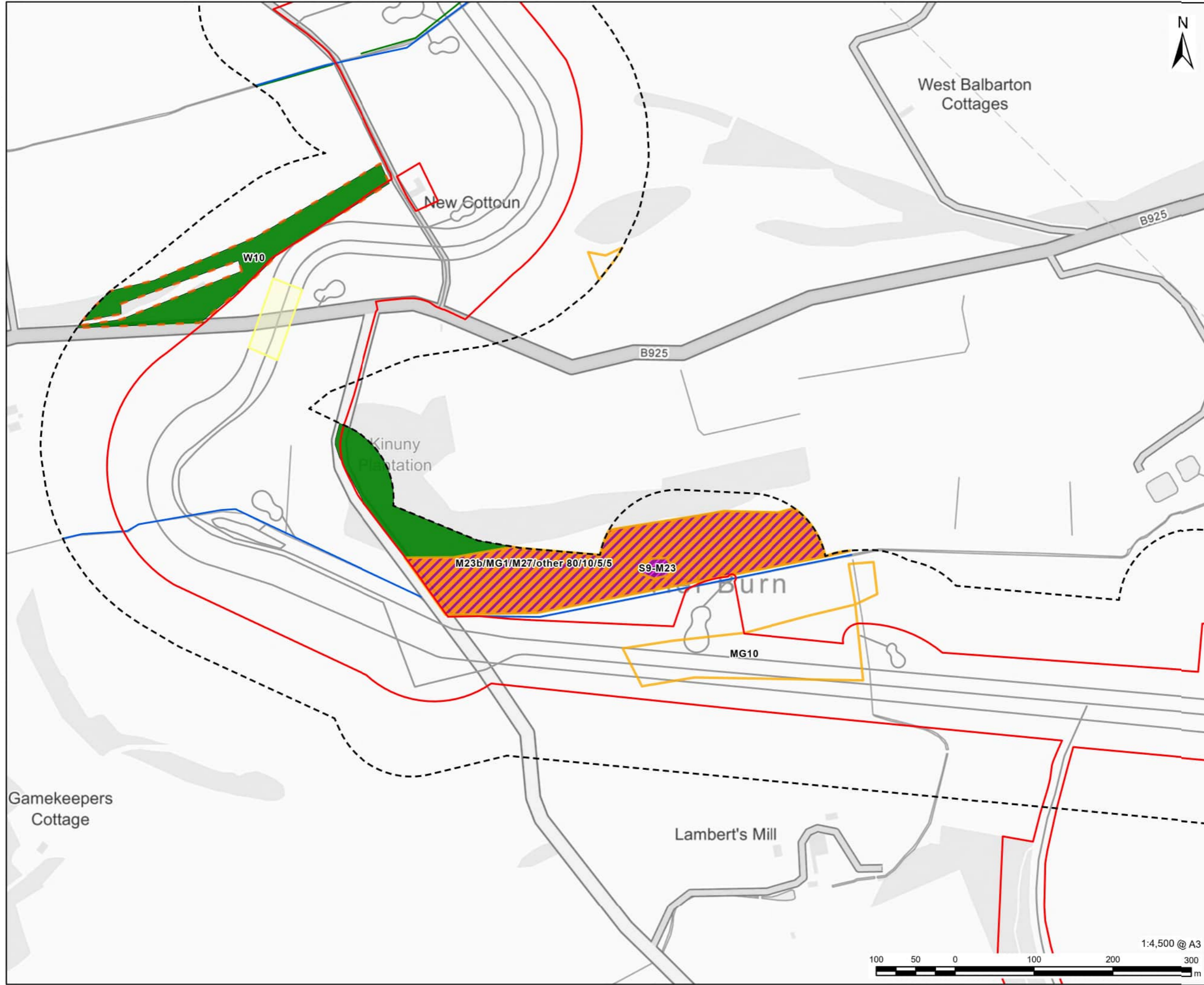

- LEGEND**
- Planning Application Boundary
  - Habitat Survey Area (100m buffer of the site boundary as it was understood at the time of survey)
  - Area Not Accessed
  - Indicative Infrastructure Layout**
  - Temporary Infrastructure
  - Horizontal Direction Drilling (HDD) Section
  - Ground Water Dependency**
  - Potential for Partial High Ground Water Dependency
  - Potential for Moderate Ground Water Dependency
  - SBL Priority / Noteworthy Habitat**
  - Hedgerow
  - River
  - Lowland Fen
  - Lowland Mixed Deciduous Woodland
  - Purple Moor Grass and Rush Pasture



**NOTES**  
Note: Habitat labels depict NVC Communities  
Contains OS data © Crown copyright 2025

**ISSUE PURPOSE**  
EIA REPORT

**PROJECT NUMBER**  
60707131

**FIGURE TITLE**  
Scottish Biodiversity List (SBL) Priority Habitats and Otherwise Noteworthy Habitats

**FIGURE NUMBER**  
Figure 7.5 (Sheet 8 of 12)

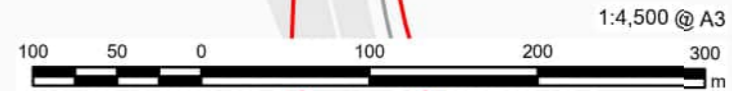

This drawing has been prepared for the use of AECOM's client. It may not be used, modified, reproduced or relied upon by third parties, except as agreed by AECOM or as required by law. AECOM accepts no responsibility, and disclaims any liability whatsoever, to any party that uses or relies on this drawing without AECOM's express written consent. Do not scale this document. All measurements must be obtained from the stated dimensions.

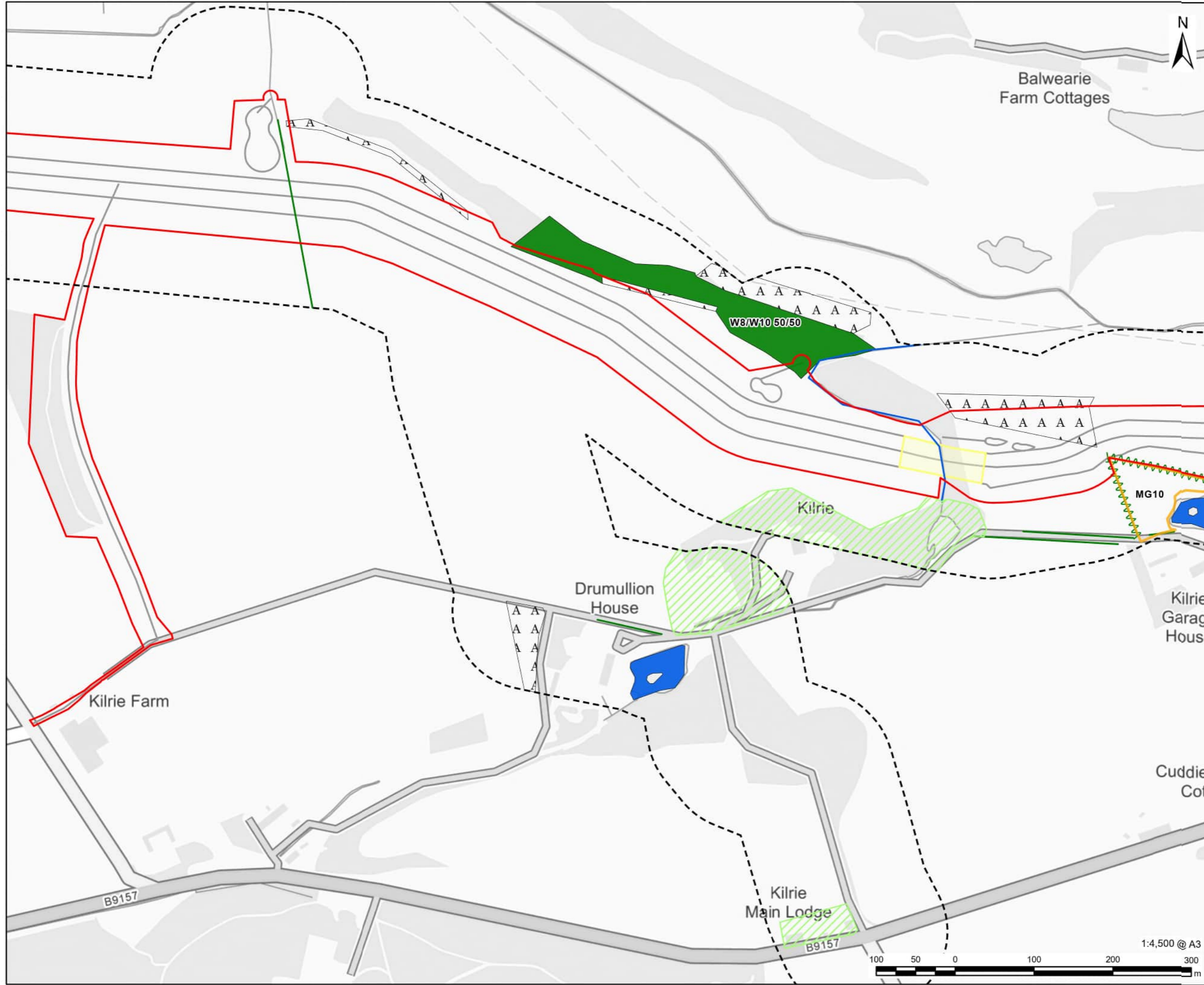

- Planning Application Boundary
- Habitat Survey Area (100m buffer of the site boundary as it was understood at the time of survey)
- Area Not Accessed
- Indicative Infrastructure Layout
- Temporary Infrastructure
- Horizontal Direction Drilling (HDD) Section
- Ground Water Dependency
- Potential for Moderate Ground Water Dependency
- SBL Priority / Noteworthy Habitat
- Hedgerow (species-rich)
- Hedgerow
- River
- Arable Field Margin
- Eutrophic Standing Water
- Lowland Mixed Deciduous Woodland



NOTES

Note: Habitat labels depict NVC Communities Contains OS data © Crown copyright 2025

ISSUE PURPOSE

EIA REPORT

PROJECT NUMBER

60707131

FIGURE TITLE

Scottish Biodiversity List (SBL) Priority Habitats and Otherwise Noteworthy Habitats

FIGURE NUMBER

Figure 7.5 (Sheet 9 of 12)



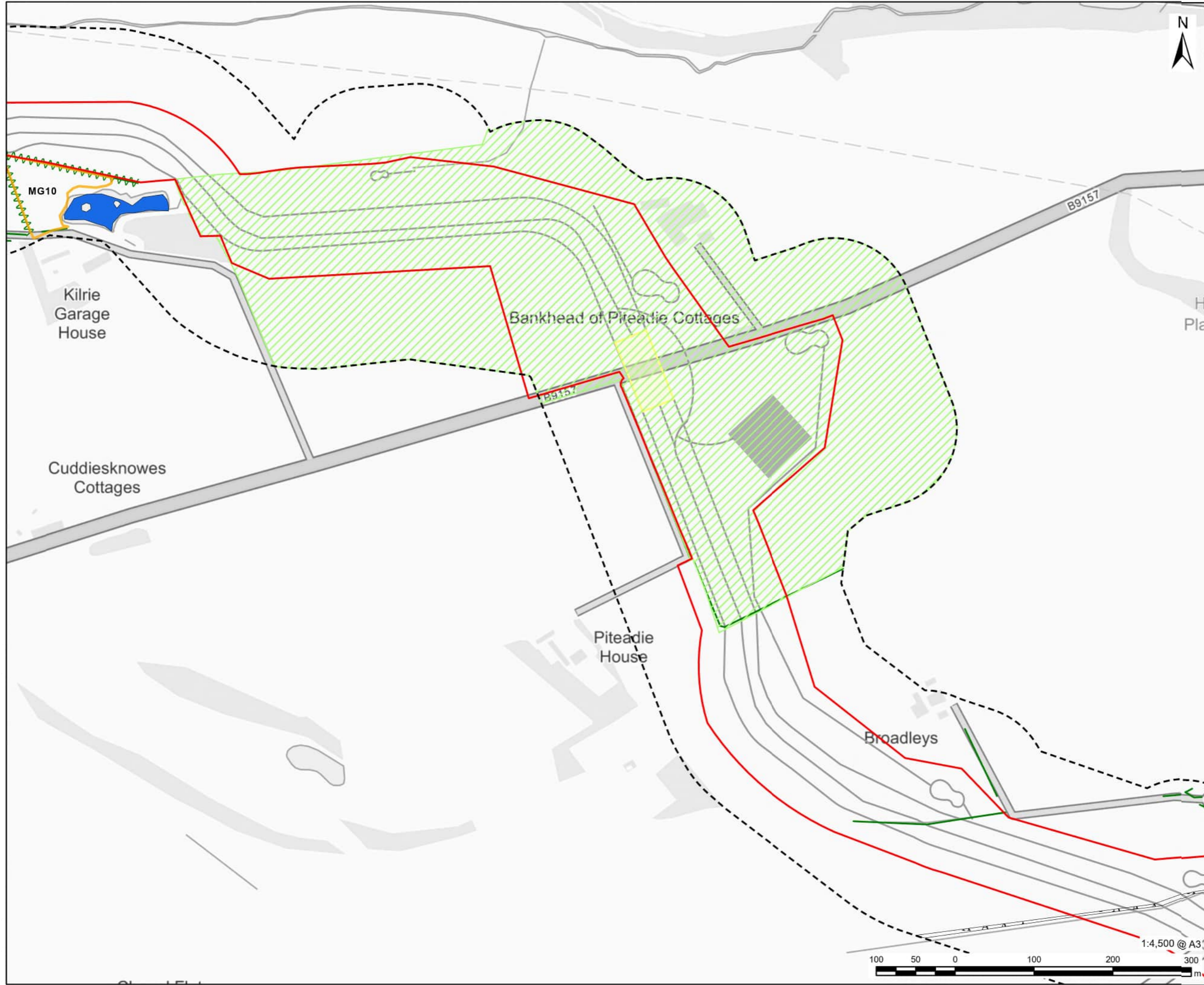

# AECOM

**PROJECT**

Eastern Green Link 4

**CLIENT**

SP Energy Networks

**CONSULTANT**

AECOM Limited  
One Trinity Gardens  
Newcastle  
NE1 2HF  
www.aecom.com

**LEGEND**

- Planning Application Boundary
- Habitat Survey Area (100m buffer of the site boundary as it was understood at the time of survey)
- Area Not Accessed
- Indicative Infrastructure Layout
- Temporary Infrastructure
- Horizontal Direction Drilling (HDD) Section
- Ground Water Dependency
- Potential for Moderate Ground Water Dependency
- SBL Priority / Noteworthy Habitat
- Hedgerow (species-rich)
- Hedgerow
- Arable Field Margin
- Eutrophic Standing Water



**NOTES**

Note: Habitat labels depict NVC Communities Contains OS data © Crown copyright 2025

**ISSUE PURPOSE**

EIA REPORT

**PROJECT NUMBER**

60707131

**FIGURE TITLE**

Scottish Biodiversity List (SBL) Priority Habitats and Otherwise Noteworthy Habitats

**FIGURE NUMBER**

Figure 7.5 (Sheet 10 of 12)



This drawing has been prepared for the use of AECOM's client. It may not be used, modified, reproduced or relied upon by third parties, except as agreed by AECOM. AECOM accepts no responsibility, and denies any liability whatsoever, to any party that uses or relies on this drawing without AECOM's express written consent. Do not scale this document. All measurements must be obtained from the allied dimensions.

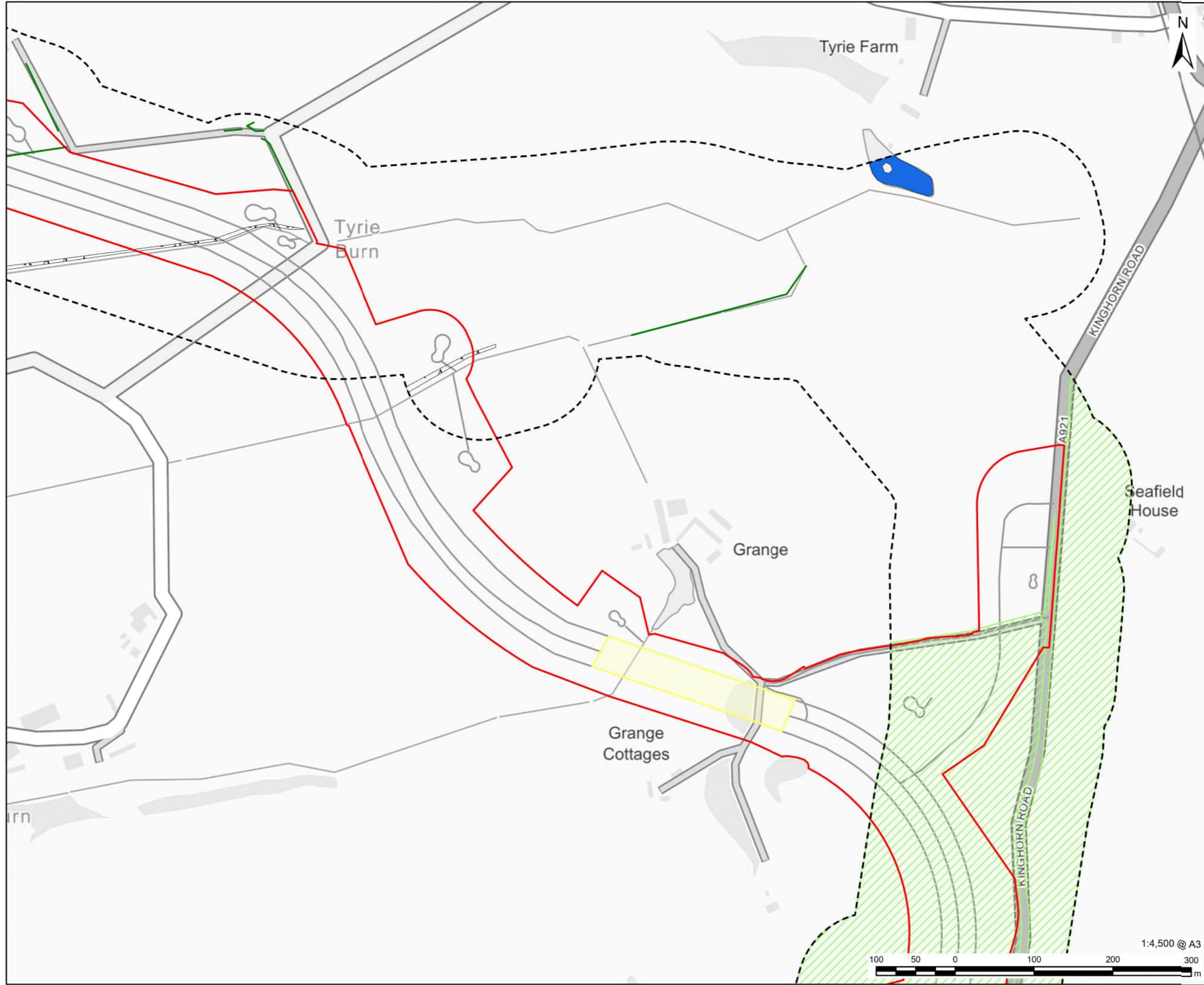

- LEGEND**
- Planning Application Boundary
  - Habitat Survey Area (100m buffer of the site boundary as it was understood at the time of survey)
  - Area Not Accessed
  - Indicative Infrastructure Layout
  - Temporary Infrastructure
  - Horizontal Direction Drilling (HDD) Section
  - SBL Priority / Noteworthy Habitat
  - Hedgerow
  - Arable Field Margin
  - Eutrophic Standing Water



**NOTES**  
Note: Habitat labels depict NVC Communities  
Contains OS data © Crown copyright 2025

**ISSUE PURPOSE**  
EIA REPORT

**PROJECT NUMBER**  
60707131

**FIGURE TITLE**  
Scottish Biodiversity List (SBL) Priority Habitats and Otherwise Noteworthy Habitats

**FIGURE NUMBER**  
Figure 7.5 (Sheet 11 of 12)

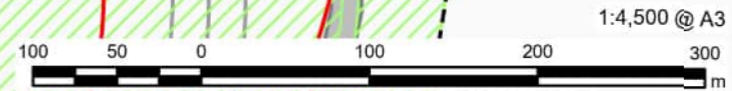

This drawing has been prepared for the use of AECOM's client. It may not be used, modified, reproduced or relied upon by third parties, except as agreed by AECOM, or as required by law. AECOM accepts no responsibility, and denies any liability whatsoever, to any party that uses or relies on this drawing without AECOM's express written consent. Do not scale this document. All measurements must be obtained from the stated dimensions.

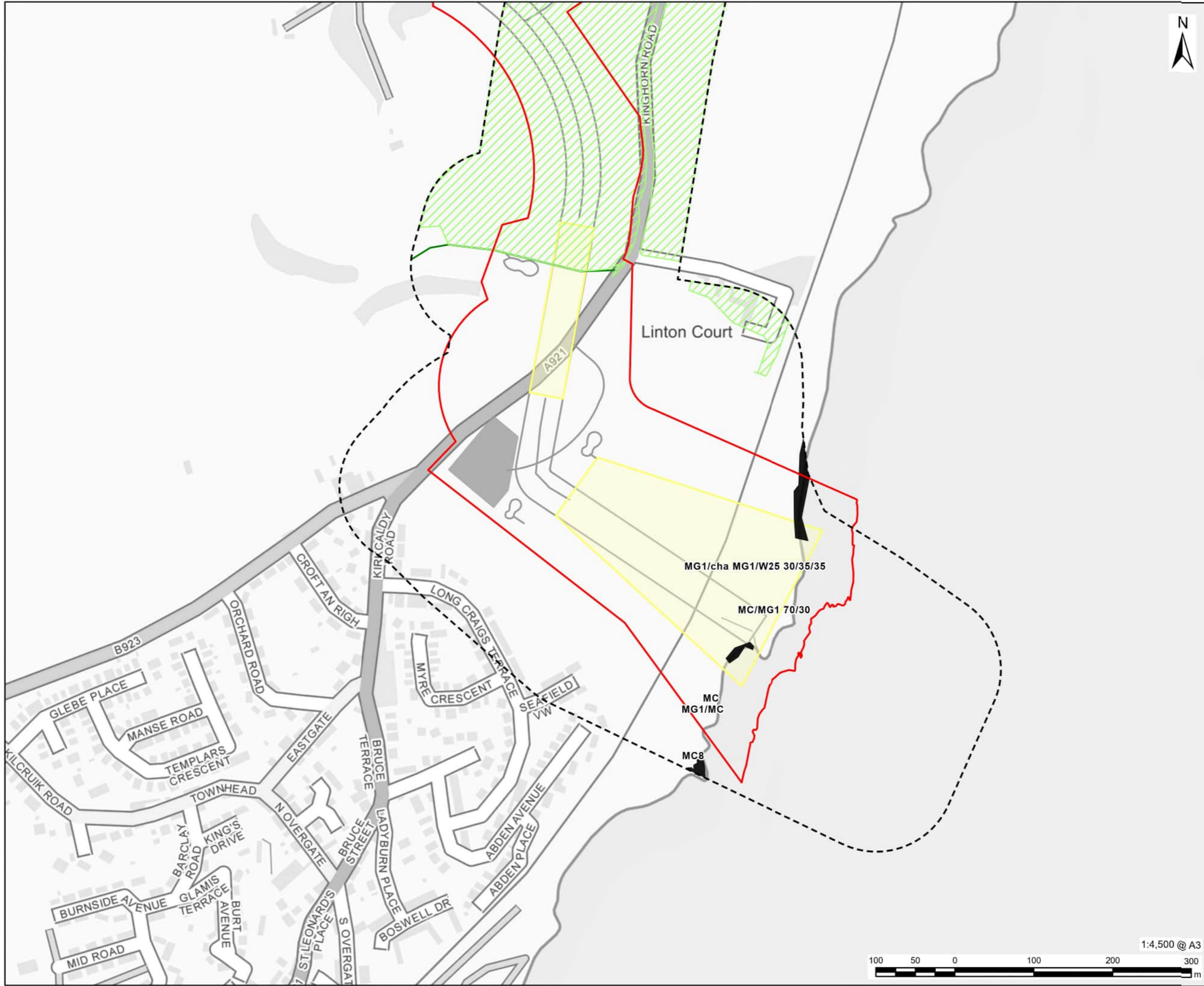

- LEGEND**
- Planning Application Boundary
  - Habitat Survey Area (100m buffer of the site boundary as it was understood at the time of survey)
  - Area Not Accessed
  - Indicative Infrastructure Layout
    - Temporary Infrastructure
    - Horizontal Direction Drilling (HDD) Section
  - SBL Priority / Noteworthy Habitat
    - Hedgerow
    - Unconfirmed Habitat Type



**NOTES**  
Note: Habitat labels depict NVC Communities  
Contains OS data © Crown copyright 2025

**ISSUE PURPOSE**

EIA REPORT

**PROJECT NUMBER**

60707131

**FIGURE TITLE**

Scottish Biodiversity List (SBL) Priority Habitats and Otherwise Noteworthy Habitats

**FIGURE NUMBER**

Figure 7.5 (Sheet 12 of 12)

